

# SENSEI TEN

PRODUCT INFORMATION GUIDE

## PRODUCT INFORMATION

### PACKAGE CONTENTS

Sensei Ten Mouse  
Product Information Guide

### STEELSERIES ENGINE SOFTWARE REQUIREMENTS

Platforms  
Windows 7+  
Mac OS X 10.8+  
120 MB of free hard drive space for installation

### SYSTEM REQUIREMENTS / COMPATIBILITY

PC / Mac / Xbox

## SETUP

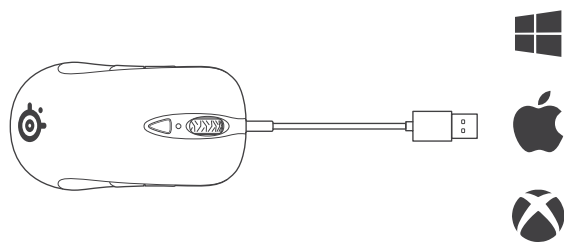

## PRODUCT OVERVIEW

- 01 Main Trigger Buttons
- 02 Scroll Wheel
- 03 CPI Button / LED
  - 400 CPI \*
  - 800 CPI \*\*
  - 1200 CPI \*\*\*
  - 2400 CPI \*\*\*\*
  - 3200 CPI \*\*\*\*\*
- 04 Side Buttons

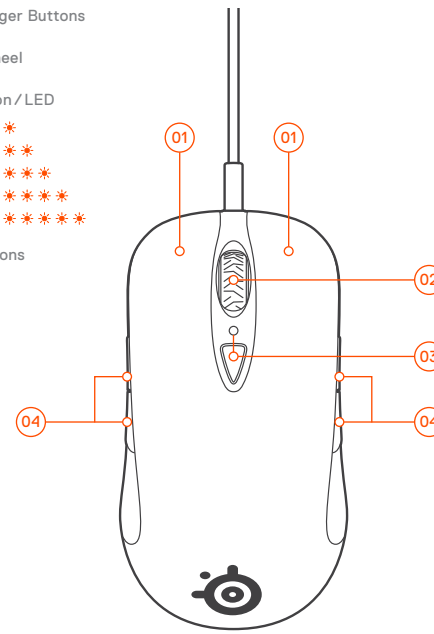

- 05 PTFE Feet
- 06 TrueMove Pro Sensor

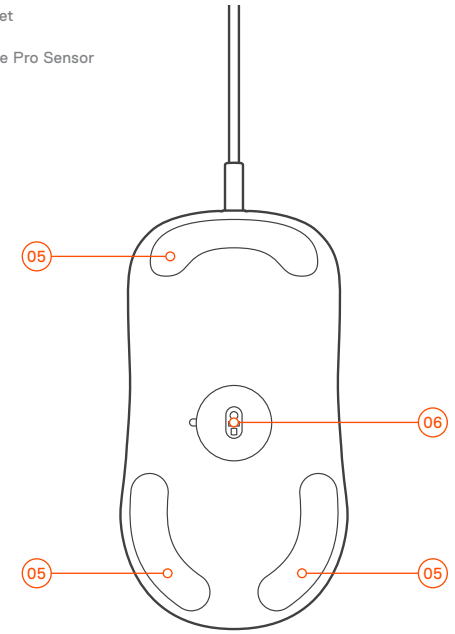

## STEELSERIES ENGINE

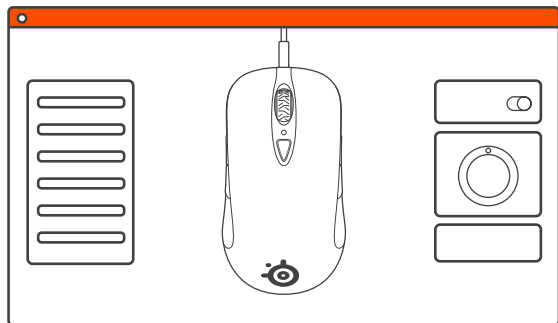

To enjoy **GameSense integration**, custom lighting effects, customization of mouse settings, as well as programming macros on your new Sensei Ten mouse, download SteelSeries Engine at [steelseries.com/engine](http://steelseries.com/engine)

## ESPAÑOL

### INFORMACIÓN DEL PRODUCTO

120 MB de espacio libre en el disco duro para la instalación

### CONTENIDO DEL PAQUETE

Ratón Sensei Ten  
Guía de información del producto

### REQUISITOS DEL SISTEMA / COMPATIBILIDAD

PC/Mac/Xbox

### REQUISITOS DEL SOFTWARE STEELSERIES ENGINE

Plataformas  
Windows 7 o superior  
Mac OS X 10.8 o superior

### DESCRIPCIÓN GENERAL DEL PRODUCTO

- 01 Botones activadores principales
- 02 Rueda de desplazamiento
- 03 Botón CPI / LED
- 04 Botones laterales
- 05 Pies de PTFE
- 06 Sensor TrueMove Pro

## 简体中文

### 产品信息

需要120MB 硬盘空间安装软件

### 包装内容

Sensei Ten 鼠标  
产品信息指南

### 系统要求/兼容性

PC / Mac / Xbox

### STEELSERIES ENGINE 软件要求

平台  
Windows 7+  
Mac OS X 10.8+

### 产品概览

- 01 主触发按钮
- 02 滚轮
- 03 CPI 按钮 / LED
- 04 侧边按钮
- 05 PTFE 脚垫
- 06 TrueMove Pro 传感器

## 繁體中文

### 產品資訊

Mac OS X 10.8+

需要 120 MB 可用硬碟空間安裝軟體

### 包裝內容

Sensei Ten 滑鼠  
產品資訊指南

### 系統要求/相容性

PC / Mac / Xbox

### STEELSERIES ENGINE 軟體需求

平台  
Windows 7+

### 產品概述

- 01 主要按鍵
- 02 滾輪
- 03 CPI 按鈕 / LED
- 04 側鍵
- 05 PTFE 腳墊
- 06 TrueMove Pro 感測器

## 日本語

### 製品情報

インストール用のハードドライブ空き容量 120MB

### パッケージの内容

Sensei Tenマウス  
製品に関する情報ガイド

### システム要件 / 互換性

PC / Mac / Xbox

### STEELSERIES ENGINE のソフトウェア要件

プラットフォーム  
Windows 7以降  
Mac OS X 10.8以降

### 製品概要

- 01 メイントリガボタン
- 02 スクロールホイール
- 03 CPI ボタン / LED
- 04 サイドボタン
- 05 PTFE フィート
- 06 TrueMove Pro センサー

## 한국어

### 제품 정보

Mac OS X 10.8 이상

### 패키지 구성품

Sensei Ten 마우스  
제품 정보 안내

### 시스템 요구 사항 / 호환성

PC / Mac / Xbox

### STEELSERIES ENGINE 소프트웨어 요구 사항

플랫폼  
Windows 7 이상

설치를 위한 120MB의 하드 드라이브 여유 공간

### 제품 개요

- 01 메인 트리거 버튼
- 02 스크롤 휠
- 03 CPI 버튼 / LED
- 04 사이드 버튼
- 05 PTFE 피트
- 06 TrueMove Pro 센서

## DEUTSCH

### PRODUKTINFORMATIONEN

Windows 7 und neuer  
Mac OS X 10.8 und neuer

### LIEFERUMFANG

Sensei Ten Mouse  
Produktinformationshandbuch

### SYSTEMANFORDERUNGEN / KOMPATIBILITÄT

PC / Mac / Xbox

### STEELSERIES ENGINE - SOFTWAREANFORDERUNGEN

Plattformen

120 MB freier Festplattenspeicher für die Installation

### PRODUKTÜBERSICHT

- 01 Hauptauslösetasten
- 02 Scroll-Rad
- 03 CPI-Taste / LED
- 04 Seitentasten
- 05 PTFE-Mausfüße
- 06 Sensor TrueMove Pro

# РУССКИЙ

## СВЕДЕНИЯ О ПРОДУКТЕ

120 Мбайт свободного места на жестком диске для установки

## КОМПЛЕКТАЦИЯ

Мышь Sensei Ten

Информационное руководство по продукту

## СИСТЕМНЫЕ ТРЕБОВАНИЯ/СОВМЕСТИМОСТЬ

PC/Mac/Xbox

## ТРЕБОВАНИЯ ПРОГРАММНОГО ПАКЕТА STEELSERIES ENGINE

Платформы

Windows 7 и более поздние Mac OS X 10.8 и более поздние

## КРАТКИЕ СВЕДЕНИЯ О ПРОДУКТЕ

- 01 Основные кнопки
- 02 Колесо прокрутки
- 03 Кнопка CPI / LED
- 04 Боковые кнопки
- 05 Фторопластовые опорные накладки
- 06 Датчик TrueMove Pro

# ITALIANO

## INFORMAZIONI SUL PRODOTTO

120 MB di spazio libero sul disco rigido per l'installazione

## CONTENUTO DELLA CONFEZIONE

Mouse Sensei Ten

Manuale del prodotto

## REQUISITI DI SISTEMA/COMPATIBILITÀ

PC/Mac/Xbox

## REQUISITI SOFTWARE STEELSERIES ENGINE

Piattaforme

Windows 7 e versioni successive Mac OS X 10.8 e versioni successive

## PANORAMICA DEL PRODOTTO

- 01 Pulsanti di attivazione principali
- 02 Rotellina di scorrimento
- 03 Pulsante CPI / LED
- 04 Pulsanti laterali
- 05 Piedini in PTFE
- 06 Sensore TrueMove Pro



### Europe – EU Declaration of Conformity

Hereby, SteelSeries ApS, declares that the equipment which is compliance with directive RoHS 2.0 (2015/863/EU), EMC Directive (2014/30/EU), and LVD (2014/35/EU) which are issued by the Commission of the European Community. The full text of the EU declaration of conformity is available at the following internet address: <https://steelseries.com/>

Operating Temperature: 0 to + 40 °C

SteelSeries ApS, hereby confirms, to date, based on the feedback from our suppliers indicates that our products shipping to the EU territory comply with REACH (Registration, Evaluation, Authorization, and Restriction of Chemicals - (EC) 1907/2006) compliance program. We are fully committed to offering REACH compliance on the products and posting accurate REACH compliance status for the all of products.



### WEEE

This product must not be disposed of with your other household waste or treat them in compliance with the local regulations or contact your local city office, your household waste disposal service or the shop where you purchased the product.



Türkiye Cumhuriyeti: EEEE Yönetmeliğine Uygundur



### UK Declaration of Conformity

Hereby, SteelSeries ApS, declares that the following equipment which is compliance with Electromagnetic Compatibility Regulations 2016, Electrical Equipment (Safety) Regulations 2016, Radio Equipment Regulations 2017 and The Restriction of the Use of Certain Hazardous Substances in Electrical and Electronic Equipment Regulations 2012 issued by the Department for Business, Energy & Industrial Strategy. The full text of the UK declaration of conformity is available at the following internet address: <https://steelseries.com/>

### Ukraine RoHS:

Обладнання відповідає вимогам Технічного регламенту щодо обмеження використання деяких небезпечних речовин в електричному та електронному обладнанні, затвердженого постановою Кабінету Міністрів України від 3 грудня 2008 № 1057

This product is compliant with requirements of Vietnam Circular No. 30/2011/TT-BCT Regulations "STIPULATING TEMPORARILY THE PERMISSIBLE CONTENT LIMITATION OF SOME TOXIC CHEMICALS IN THE ELECTRONIC, ELECTRICAL PRODUCTS" Restriction on Hazardous Substances statement (India) This product complies with the "India E-waste Rule 2011" and prohibits use of lead, mercury, hexavalent chromium, polybrominated biphenyls or polybrominated diphenyl ethers in concentrations exceeding 0.1 weight % and 0.01 weight % for cadmium, except for the exemptions set in Schedule 2 of the Rule.

### 《废弃电器电子产品回收处理管理条例》提示性说明

为了更好地关爱及保护地球,当用户不再需要此产品或产品寿命终止时,请遵守国家废弃电器电子产品回收处理相关法律法规,将其交给当地具有国家认可的回收处理资质的厂商进行回收处理。

# FRANÇAIS

## INFORMATIONS SUR LE PRODUIT

120 Mo d'espace disque dur libre pour l'installation

## CONTENU DE L'EMBALLAGE

Souris Sensei Ten

Guide d'informations sur le produit

## CONFIGURATION SYSTÈME REQUISE / COMPATIBILITÉ

PC / Mac / Xbox

## EXIGENCES DU LOGICIEL STEELSERIES ENGINE

Plateformes

Windows 7 + Mac OS X 10.8 +

## VUE D'ENSEMBLE DU PRODUIT

- 01 Boutons de déclenchement principaux
- 02 Molette de défilement
- 03 Bouton CPI / LED
- 04 Boutons latéraux
- 05 Pattes en PTFE
- 06 Capteur TrueMove Pro

# PORTUGUÊS

## INFORMAÇÕES DO PRODUTO

Windows 7 + Mac OS X 10,8 +

## CONTEÚDOS DA EMBALAGEM

Rato Sensei Ten

Guia de Informações do Produto

## COMPATIBILIDADE/REQUISITOS DO SISTEMA

PC/Mac/Xbox

## REQUISITOS DO SOFTWARE STEELSERIES ENGINE

Plataformas

Disco rígido de 120 MB de espaço livre para instalação

## VISÃO GERAL DO PRODUTO

- 01 Botões acionadores principais
- 02 Roda do rato
- 03 Botão CPI / LED
- 04 Botões laterais
- 05 Patins em PTFE
- 06 Sensor TrueMove Pro



### Federal Communication Commission Interference Statement

This device complies with Part 15 of the FCC Rules. Operation is subject to the following two conditions: (1) This device may not cause harmful interference, and (2) this device must accept any interference received, including interference that may cause undesired operation. This equipment has been tested and found to comply with the limits for a Class B digital device, pursuant to Part 15 of the FCC Rules. These limits are designed to provide reasonable protection against harmful interference in a residential installation. This equipment generates, uses and can radiate radio frequency energy and, if not installed and used in accordance with the instructions, may cause harmful interference to radio communications. However, there is no guarantee that interference will not occur in a particular installation. If this equipment does cause harmful interference to radio or television reception, which can be determined by turning the equipment off and on, the user is encouraged to try to correct the interference by one of the following measures:

- Reorient or relocate the receiving antenna.
- Increase the separation between the equipment and receiver.
- Connect the equipment into an outlet on a circuit different from that to which the receiver is connected.
- Consult the dealer or an experienced radio/TV technician for help.

### Industry Canada Statement:

This device complies with RSS standards of the Industry Canada Rules. Operation is subject to the following two conditions: (1) This device may not cause harmful interference, and (2) this device must accept any interference received, including interference that may cause undesired operation.

Ce dispositif est conforme à la norme CNR d'Industrie Canada applicable aux appareils radio exempts de licence. Son fonctionnement est sujet aux deux conditions suivantes: (1) le dispositif ne doit pas produire de brouillage préjudiciable, et (2) ce dispositif doit accepter tout brouillage reçu, y compris un brouillage susceptible de provoquer un fonctionnement indésirable. This Class B digital apparatus complies with Canadian ICES-003. Cet appareil numérique de la classe B est conforme à la norme NMB-003 du Canada.

이 기기는 가정용(B급) 전자파적합기기로서 주로 가정에서 사용하는 것을 목적으로 하며, 모든 지역에서 사용할 수 있습니다



1. 상호명: SteelSeries ApS.
2. 기기명칭: Mouse
3. 모델명: M-00029
4. 인증번호:R-R-SS4-M-00029
5. 제조사/제조국: SteelSeries ApS./China



この装置は、クラスB機器です。この装置は、住宅環境で使用することを目的としていますが、この装置がラジオやテレビジョン受信機に近接して使用されると、受信障害を引き起こすことがあります。取扱説明書に従って正しい取り扱いをして下さい。VCCI-B



该电子电气产品含有某些有害物质, 在环保使用期限内可以放心使用, 超过环保使用期限之后则应该进入回收循环系统。



ACMA Compliance (Australia/ New-Zealand)



Custom Union Compliance. (Russia / Belarus / Kazakhstan)



Direct Current

The RoHS test method is based on the standards JIS C 0950 and CNS 15663.

設備名稱 Equipment name	滑鼠 Mouse	型號 (型式) Type designation			M-00029	
單元 Unit	限用物質及其化學符號 Restricted substances and its chemical symbols					
	鉛 Lead (Pb)	汞 Mercury (Hg)	鎘 Cadmium (Cd)	六價鉻 Hexavalent-chromium (Cr <sup>VI</sup> )	多溴聯苯 Polybrominated biphenyls (PBB)	多溴二苯醚 Polybrominated diphenyl ethers (PBDE)
塑膠部件 Plastic	○	○	○	○	○	○
電路板及元件 PCBA	—	○	○	○	○	○
線材 Cables	—	○	○	○	○	○
金屬部件 Metal	—	○	○	○	○	○

備考1. "超出0.1 wt %及"超出0.01 wt %"係指限用物質之百分比含量超出百分比含量基準值。  
Note 1: "Exceeding 0.1 wt %" and "exceeding 0.01 wt %" indicate that the percentage content of the restricted substance exceeds the reference percentage value of presence condition.

備考2. "○"係指該項限用物質之百分比含量未超出百分比含量基準值。  
Note 2: "○" indicates that the percentage content of the restricted substance does not exceed the percentage of reference value of presence.

備考3. "—"係指該項限用物質為排除項目。  
Note 3: The "—" indicates that the restricted substance corresponds to the exemption

根据中国大陆《电子电气产品有害物质限制使用标识要求》，以下部分列出了产品中可能包含的有害物质的名称和含量：						
零部件名称	有害物质					
	鉛 (Pb)	汞 (Hg)	鎘 (Cd)	六價鉻 (Cr <sup>VI</sup> )	多溴聯苯 (PBB)	多溴二苯醚 Polybrominated diphenyl ethers (PBDE)
电路板组件	x	○	○	○	○	○
其他线材	x	○	○	○	○	○

\* :电路板组件包括印刷电路板及其构成的零部件,如电阻、电容、集成电路、连接器等。

本表格依据SJ/T 11364的规定编制。

○:表示该有害物质在该部件所有均质材料中的含量均在 GB/T 26572规定的限量要求以下。  
X:表示该有害物质至少在该部件的某一均质材料中的含量超出GB/T 26572规定的限量要求;  
上表中打“X”的部件,应功能需要,部分有害物质含量超出GB/T 26572规定的限量要求,但是符合欧盟RoHS法规要求(属于豁免部分)。

Region	Address	Telephone
Asia 亞洲	4F.-4, No. 186, Jian 1st Rd., Zhonghe Dist., New Taipei City 235603, Taiwan 新北市中和區建一路186號4樓及4樓之4	+886 2 8227 1999
Europe	Havneholmen 8, 1 <sup>st</sup> Floor, 2450 Copenhagen SV, Denmark	+45 702 500 75
USA	656 W Randolph St., Suite 3E, Chicago, IL 60661, USA	+1 312 258 9467

More information and support at [steelseries.com](http://steelseries.com)

Product Name(產品名稱/产品名称): Gaming Mouse (滑鼠/鼠标)  
Model No. (型號/型号): M-00029

Rated (規格/規格): 5V 200mA  
Made in China 中國製造/中国製造  
Operating Temperature: 0 to + 40 °C



**FR**  
Cet appareil et ses accessoires se recyclent

À DÉPOSER EN MAGASIN

OU

À DÉPOSER EN DÉCHÈTERIE

Points de collecte sur [www.quefairedemesdechets.fr](http://www.quefairedemesdechets.fr)